

INITIAL DESIGN

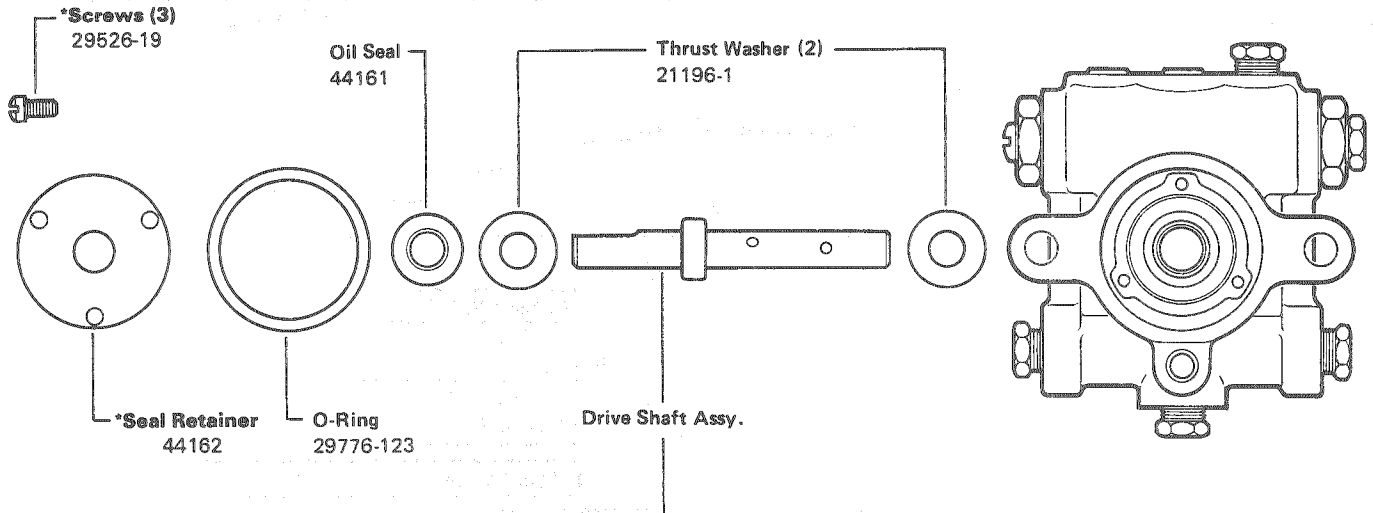

Gear Size	SINGLE STAGE		TWO STAGE	
	DO Code	DM Code	DO Code	DM Code
1/4"	*49601	*49601-1	49606	49606-1
3/8"	49602	49602-1	49607	49607-1
1/2"	49603	49603-1	49608	49608-1
3/4"	49604	49604-1	49609	49609-1
1"	49605	49605-1		

*obsolete - no longer available

NOTE: The above parts will be available until existing stock is depleted.

SEAL PRESSED IN BODY

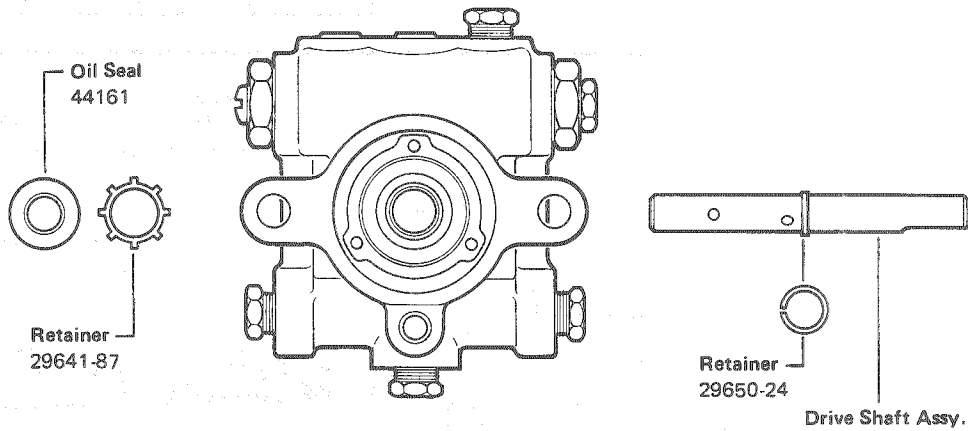

Gear Size	SINGLE STAGE		TWO STAGE	
	DO Code	DM Code	DO Code	DM Cod
1/4"	49231	49231-1	49236	49236-1
3/8"	49232	49232-1	49237	49237-1
1/2"	49233	49233-1	49238	49238-1
3/4"	49234	49234-1	49239	49239-1
1"	49235	49235-1		

2 STAGE GEAR STACK

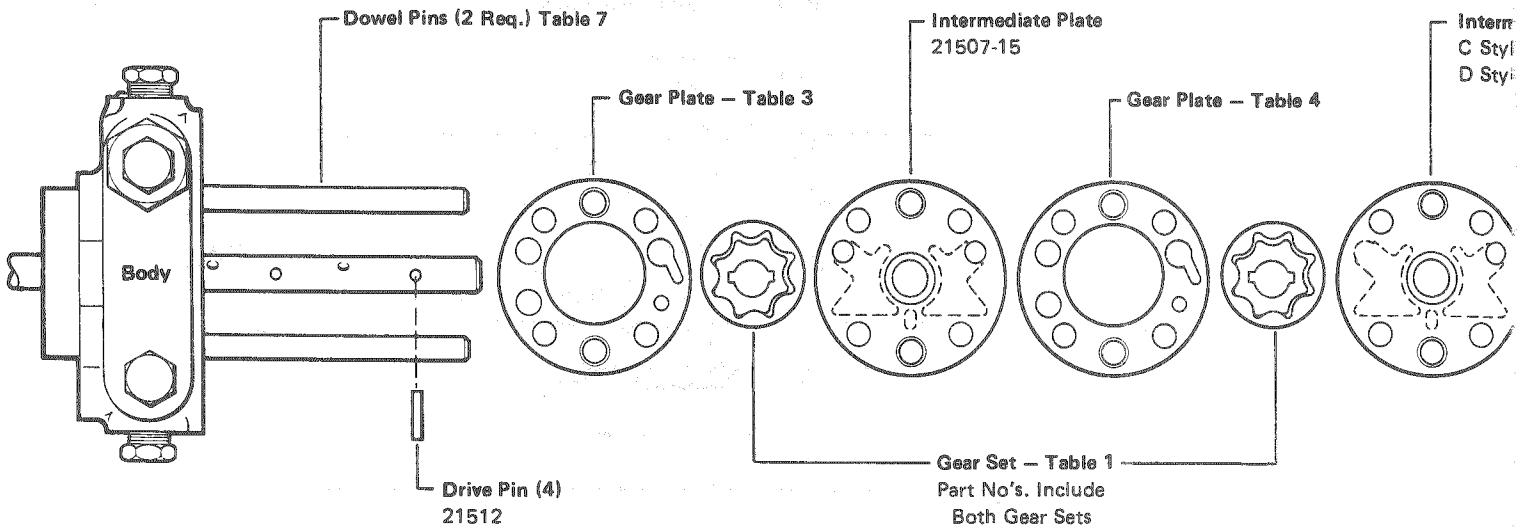

SINGLE STAGE GEAR STACK

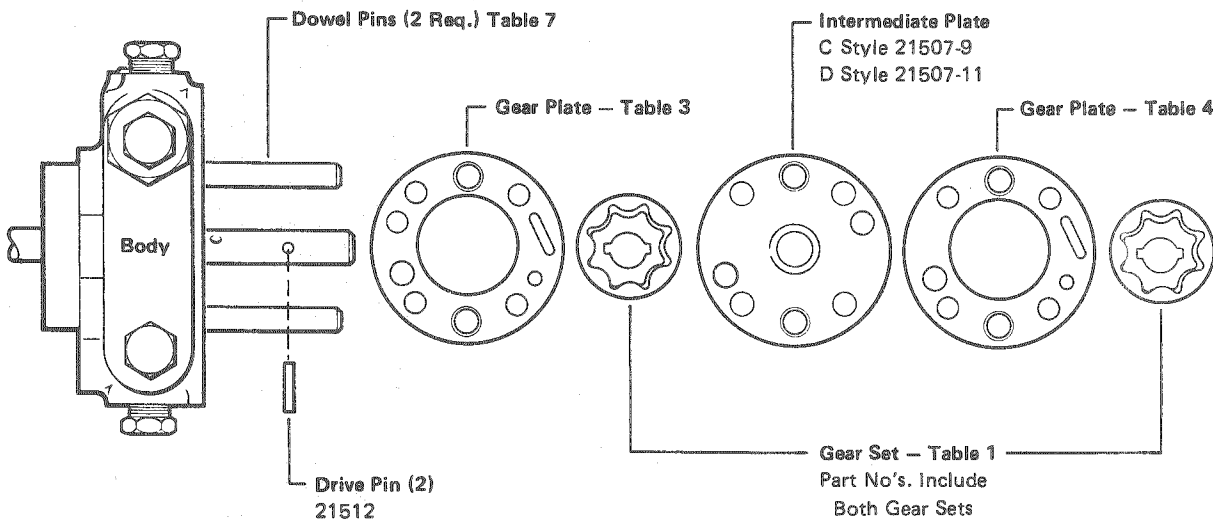

	GEAR SIZE		PRESSURE GEAR	SUCTION GEAR
	Pressure	Suction	Table 1	Table 2
SINGLE STAGE	1/4"	NONE	(2) 49489-2	NONE
	3/8"	NONE	(2) 49489-3	NONE
	1/2"	NONE	(2) 49489-4	NONE
	3/4"	NONE	(2) 49489-5	NONE
	1"	NONE	(2) 49489-6	NONE
TWO STAGE	1/4"	3/8"	(2) 49489-2	(2) 49489-3
	3/8"	1/2"	(2) 49489-3	(2) 49489-4
	1/2"	3/4"	(2) 49489-4	(2) 49489-5
	3/4"	1"	(2) 49489-5	(2) 49489-6

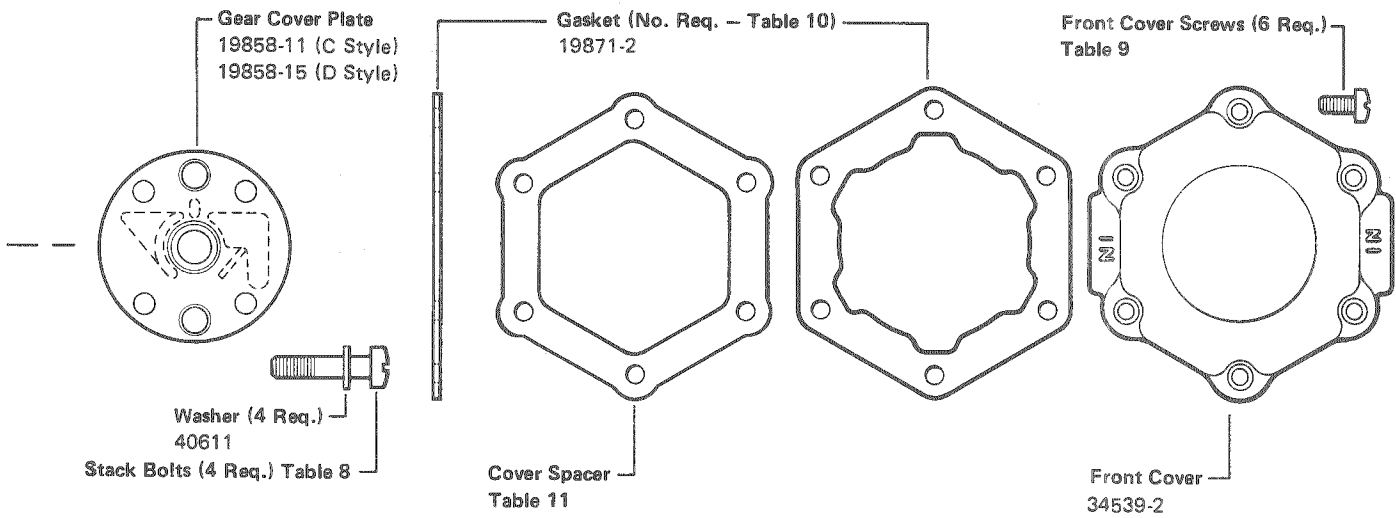
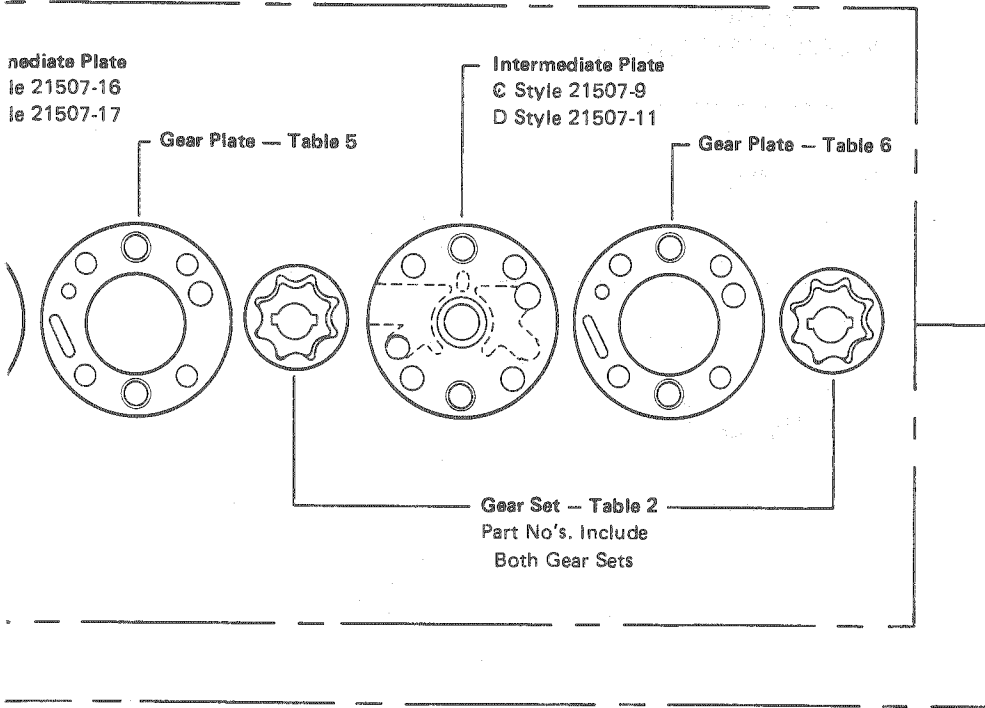

PRESSURE GEAR PLATE		SUCTION GEAR PLATE		DOWEL PIN	STACK BOLT	COVER SCREW	NO. OF GASKETS	SPACER
Table 3	Table 4	Table 5	Table 6	Table 7	Table 8	Table 9	Table 10	Table 11
24818-5	24818-3	NONE	NONE	20149-4	29521-49	29521-78	1	NONE
25082-5	25082-3	NONE	NONE	20149-2	29521-50	29521-78	1	NONE
(2)24818-5	(2)24818-3	NONE	NONE	20149-10	29521-51	29521-78	1	NONE
(2)25082-5	(2)25082-3	NONE	NONE	20149-3	29521-46	29521-78	1	NONE
(1)24818-5	(1)24818-3	NONE	NONE	20149-9	29521-55	29521-69	2	25084-1
(2)25082-5	(2)24082-3							
24818-6	29818-6	25082-3	25082-3	20149-16	29521-100	29521-69	2	25084-1
25082-6	25082-6	(2)24818-3	(2)24818-3	20149-17	29521-101	29521-68	2	25656-1
(2)24818-6	(2)24818-6	(2)25082-3	(2)25082-3	20149-18	29522-250	29521-104	3	25084-1 25656-1
(2)25082-6	(2)25082-6	(1)24818-3 (2)25082-3	(1)24818-3 (2)25082-3	20149-19	29522-251	29521-105	4	(1)25084-1 (2)25656-1

TWO STAGE PLATE POSITIONING

Nozzle (D Style)

Nozzle (C Style)

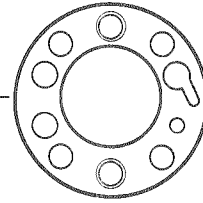
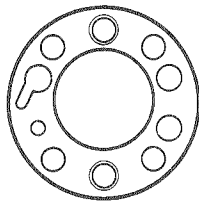

Inlet

Inlet

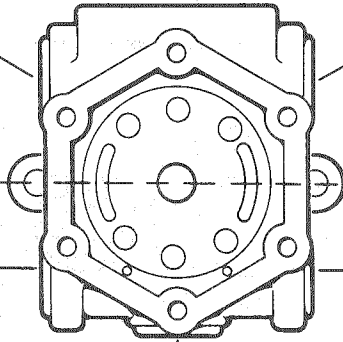

Return

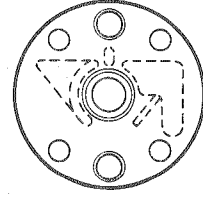
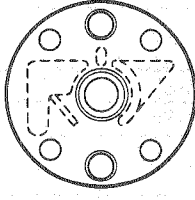
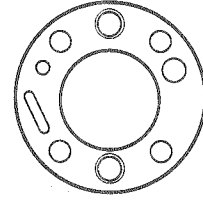
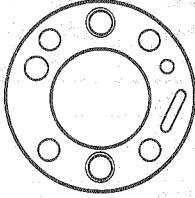
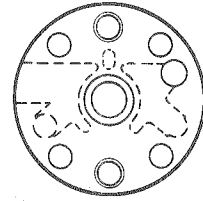
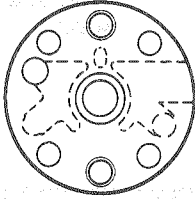
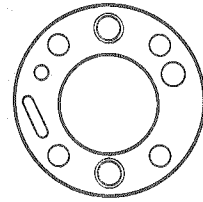
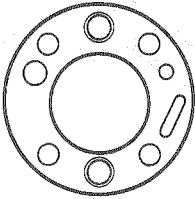
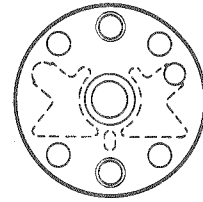
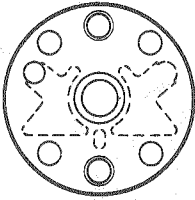
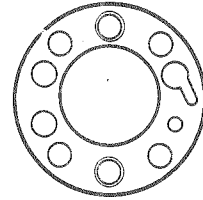
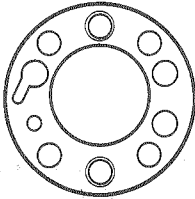
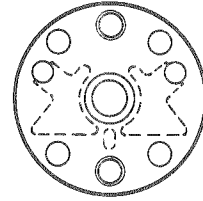
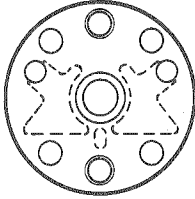

C STYLE

D STYLE

SINGLE STAGE PLATE POSITIONING

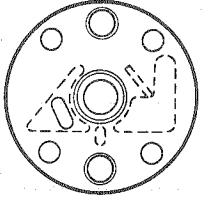
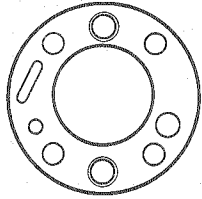
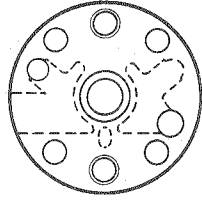
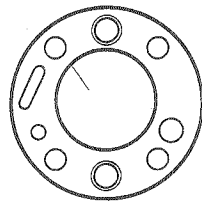
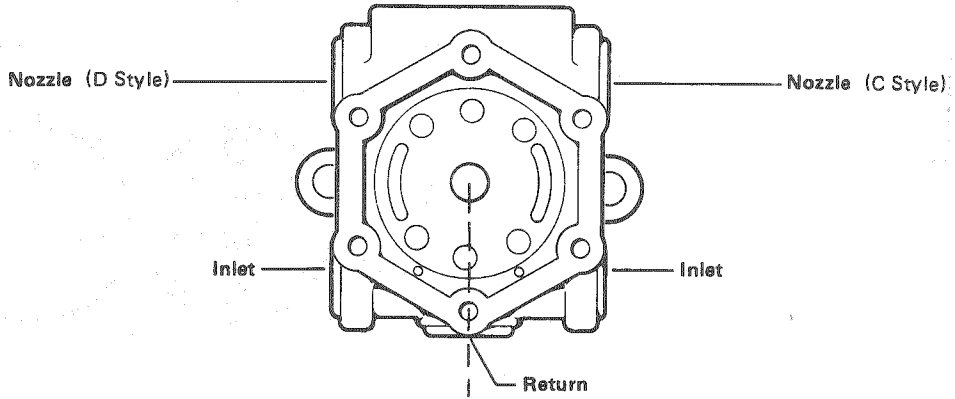

C STYLE

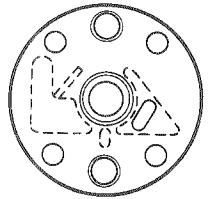
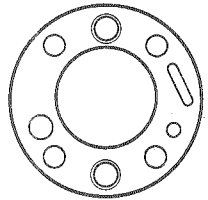
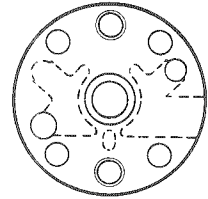
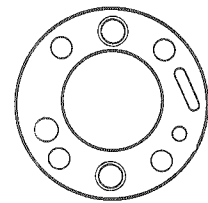

D STYLE